

MOUNTING THE ROLLER BLIND ON A CASSETTE TO THE WINDOW FRAME

1.

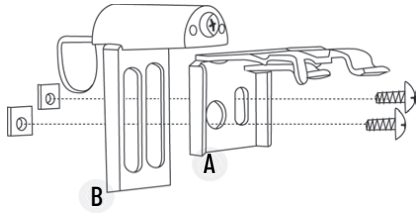

Using screws and rectangular nuts, fix the roller brackets (A) to the window frame brackets (B). If the window is fitted with a ventilator, fix the elements (A) as low as possible in relation to the elements (B).

2.

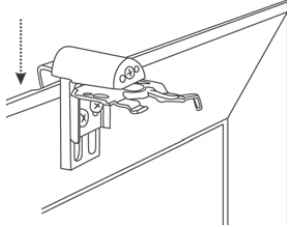

Place the joined brackets on the window sash frame.

3.

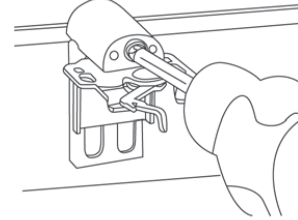

Tighten the bracket gently to the window frame with a screwdriver.

4.

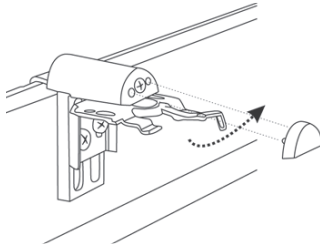

Put on a cap and then slide off the clip.

5.

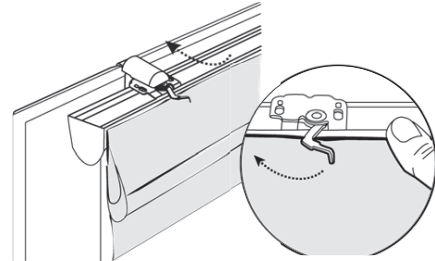

Place the roller blind cassette slightly from above, so that the slat overlaps the teeth of the roller blind holder. Tighten the clip by gently pressing it towards the window.

Chain tensioner attachment

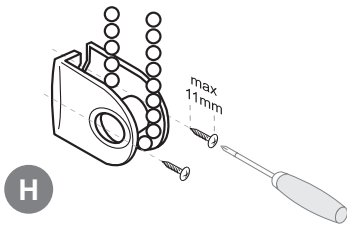

H

I

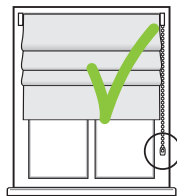
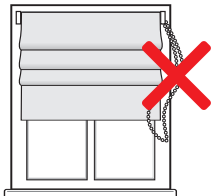

To prevent the chain from hanging loosely next to the window, we recommend installing the included chain tensioner. Installation with screws (fig. H) or adhesive tape (fig. I).



WARNING!



Danger of suffocation!

Keep cords and chain loops out of the reach of small children!

There are small parts in the package!

The child may swallow and choke on small parts!